



"Apollo"® Press



contents

technical data	3
system data	3
installation guidelines	4
 fittings	7
90° elbow	8
45° elbow	10
tees	11
couplings	15
fitting reducers	17
adapters	18
flange adapters	20
unions	21
caps	22

system data

product features

- broadest press fitting & valve product offering
- lead free options
- 300 psi max pressure rating
- deeper cut depth - better seat, tighter seal, straighter runs
- patented Leak Before Press® technology
- visual press inspection band for large diameter fittings

“Apollo”® Press is a copper press connection system designed for joining copper pipes ranging in size from ½” through 4”. Like all press systems in our portfolio, “Apollo”® Press utilizes the Leak Before Press® technology, ensuring a secure and reliable connection. The fittings and valves are equipped with EPDM sealing elements and have a pressure rating of up to 300 psi, ideal for a variety of plumbing and heating installations.

“Apollo”® Press stands out with its ease of installation, eliminating the need for heat or flame, and reducing both labor and installation costs. Additionally, our innovative press technology includes color-coded visual control rings (VCR) that offer a clear indication when the joint has been pressed, providing installers with added confidence during installation. With ApolloPress®, you gain the advantage of a high-quality, efficient solution for press fittings and valves.

operating parameters

“Apollo”® Press fittings and valves must be installed using ASTM B88 compliant tubing Types K, L, M hard copper (½” to 4”) or soft drawn annealed (½” to 1¼”)

maximum pressure

- 300 psi

temperature range

- 0°F to 250°F

standard materials list

large diameter fittings

body	UNS C12200 copper
grab ring	316/304 stainless steel
spacer ring	acetal copolymer
sealing element	EPDM
lubrication	silicone, ANSI/NSF-61 listed

small diameter fittings

body	UNS C12200 copper
sealing element	EPDM
lubrication	silicone, ANSI/NSF-61 listed

brass fittings

body	UNS C27451 brass
sealing element	EPDM
lubrication	silicone, ANSI/NSF-61 listed

certifications & listings

- ANSI/IAPMO/CAN Z1117
- NSF/ANSI 61
- NSF/ANSI 372

compliant with

- ASME B16.51
- ICC-ES 1002
- Uniform Plumbing Code (UPC®)
- International plumbing code (IPC®)
- International Residential Code® (IRC)
- National Standard Plumbing Code (NSPC)
- National Plumbing Code of Canada

approved tools

- Milwaukee®
- Rigid®
- REMS®
- DeWalt®
- NIBCO® (up to 2”)
- Rothenberger®
- Stanley-Virax®

approved applications

- compressed air
- fire sprinkler system
- heating and cooling
- industrial gas application
- potable water
- steam

Application approval for “Apollo”® Press is dependent on the suitability of the selected sealing element’s performance characteristics and limitations. Please refer to the “Apollo”® Press technical data sections for a full list of approved applications and sealing element-specific requirements.

service	pressure	temperature	EPDM
hot & cold potable water	300 psi	0°F - 250°F	✓
rainwater / gray water	300 psi	0°F - 250°F	✓
chilled water	300 psi	0°F - 250°F	✓
hydronic heating	300 psi	0°F - 250°F	✓
cooling water	200 psi	32°F - 250°F	✓
low-pressure steam	up to 15 psi	248°F	✓
ethanol	200 psi	32°F - 250°F	✓
compressed air	200 psi	32°F - 250°F	✓
oxygen (non-medical)	140 psi	up to 140°F	✓
nitrogen	200 psi	32°F - 250°F	✓
carbon dioxide	200 psi	32°F - 250°F	✓
argon	200 psi	ambient	
hydrogen	125 psi	0°F - 250°F	✓
vacuum	29.2 in Hg	0°F - 160°F	

warranty

- “Apollo”® Press® fittings: 50 year warranty
- “Apollo”® Press® valves: 5 year warranty

installation guidelines

small diameter fitting & valves (1/2" - 2")

It is the responsibility of the end-user to follow all instructions for installing Apollo® Press fittings and valves. Failure to follow these instructions and safe plumbing practices may result in extensive property damage, serious injury or death.

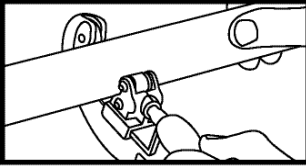

1. cutting the tube to length

After measuring, cut the tube square using a rotary tube cutter, a fine-toothed saw, or displacement-type cutter suitable for copper tubing. The tube must always be cut completely through at a 90° angle. Do not partially cut the tube and break it off as this could potentially cause leakage.

note: do not use grease, oil-cooled saws, or flame cutters when cutting the tube

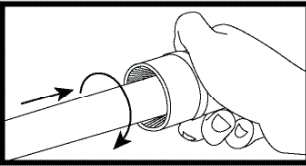

2. deburring and cleaning the tube end

Cut tube ends must be thoroughly deburred on the inside and the outside using a fine-toothed file or commercially available deburring tool. Use a Scotch-brite™ pad, wire brush, sandpaper or cloth to ensure tube ends are free of dirt and debris prior to inserting the tube. Proper tube prep is necessary to avoid any damage to the sealing element when inserting the pipe into the fitting.

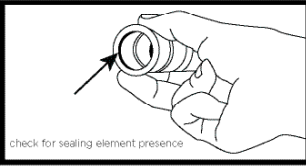

3. check the fitting

Inspect the press fitting or valve for any damage or defect. Always ensure the sealing element is present, undamaged, free of dirt and debris, and properly positioned within the fitting bead socket.

note: do not attempt to press the connection if the sealing element is damaged or not present

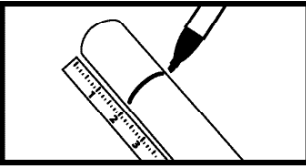

4. marking insertion depth

Using a permanent tube marker, mark the appropriate insertion depth on the copper tube with respect to the Apollo® Press insertion depth chart.

nominal pipe size (in.)	insertion depth (in.)
1/2	3/4 (0.75)
3/4	1 1/16 (0.94)
1	1 3/16 (0.94)
1 1/4	1 1/2 (1.06)
1 1/2	1 7/8 (1.44)
2	1 5/8 (1.56)

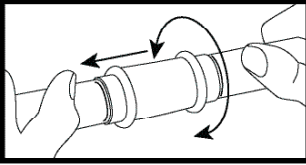

5. fitting the tube end into the connection

Insert the copper tube into the fitting or valve with twisting motion until it meets the insertion depth mark or tube stop. Failure to properly follow the required insertion depth requirements can produce an inadequate seal.

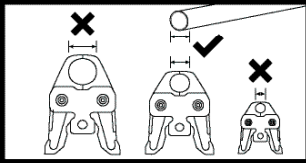

6. preparing the press tool and jaw

Using an approved press tool and jaw of correct size, open the jaw and place over the fitting or valve bead at a 90° angle to the tube centerline, ensuring that the bead is properly aligned with the groove on the inside of the jaws. Misalignment of jaws to the bead will result in an incomplete press. Before making the press connection, double-check that the tube is fully inserted to the required insertion depth.

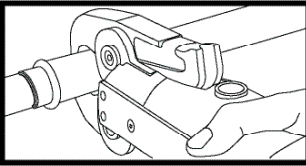

7. pressing the connection

Engage press tool trigger and begin pressing the connection. Confirm that the tool has fully cycled per the approved tool manufacturer's instructions. Disengage the trigger and open the press jaws. Be sure to visually inspect that a proper press connection has been made.

note: if desired, a fitting may be pressed a second time by repositioning the press jaw 90° from the previous pressed position, then re-press.

large diameter fittings & valves (2½" - 4")

It is the responsibility of the end-user to follow all instructions for installing Apollo® Press fittings and valves. Failure to follow these instructions and safe plumbing practices may result in extensive property damage, serious injury or death.

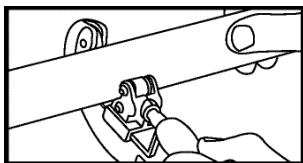

1. cutting the tube to length

After measuring, cut the tube square using a rotary tube cutter, a fine-toothed saw, or displacement-type cutter suitable for copper tubing. The tube must always be cut completely through at a 90° angle. Do not partially cut the tube and break it off as this could potentially cause leakage.

note: do not use grease, oil-cooled saws, or flame cutters when cutting the tube

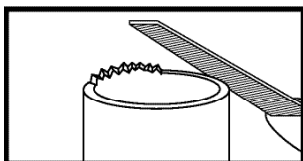

2. deburring and cleaning the tube end

Cut tube ends must be thoroughly deburred on the inside and the outside using a fine-toothed file or commercially available deburring tool. Use a Scotch-brite™ pad, wire brush, sandpaper or cloth to ensure tube ends are free of dirt and debris prior to inserting the tube. Proper tube prep is necessary to avoid any damage to the sealing element when inserting the pipe into the fitting.

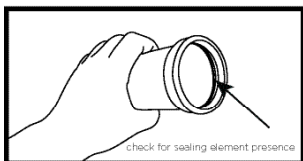

3. check the fitting

Inspect the press fitting or valve for any damage or defect. Always ensure the sealing element, spacer ring, and grip ring are present, undamaged, free of dirt and debris, and properly positioned within the fitting cup.

note: do not attempt to press the connection if the aforementioned internal components are damaged or not present

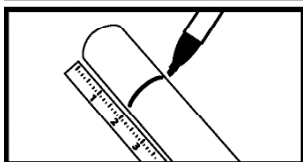

4. marking insertion depth

Using a permanent tube marker, mark the appropriate insertion depth on the copper tube with respect to the Apollo® Press insertion depth chart.

nominal pipe size (in.)	insertion depth (in.)
2½	1¾ (1.9)
3	2½ (2.1)
4	2½ (2.5)

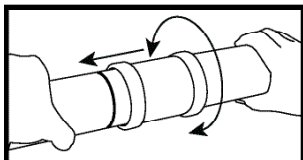

5. fitting the tube end into the connection

Insert the copper tube into the fitting or valve with twisting motion until it meets the insertion depth mark or tube stop. Failure to properly follow the required insertion depth requirements can produce an inadequate seal.

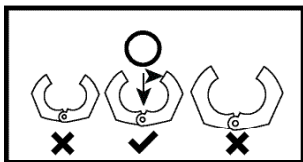

6. preparing the press tool and jaw

Using an approved press tool, actuator jaw and ring of correct size, open the ring and place over the fitting or valve bead at a 90° angle to the tube centerline, ensuring that the bead is properly aligned with the groove on the inside of the ring. Misalignment of ring to the bead will result in an incomplete press. Before making the press connection, double-check that the tube is fully inserted to the required insertion depth.

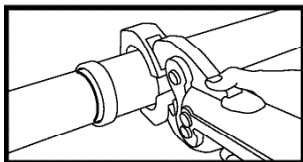

7. pressing the connection

Align the actuator jaw with the ring, engage the press tool trigger, and begin pressing the fitting or valve. Confirm that the tool has fully cycled per the approved tool manufacturer's instructions. Disengage the trigger and open the actuator jaw and press ring. Be sure to visually inspect that a proper press connection has been made.

note: if desired, a fitting may be pressed a second time by repositioning the press jaw 90° from the previous pressed position, then re-press.

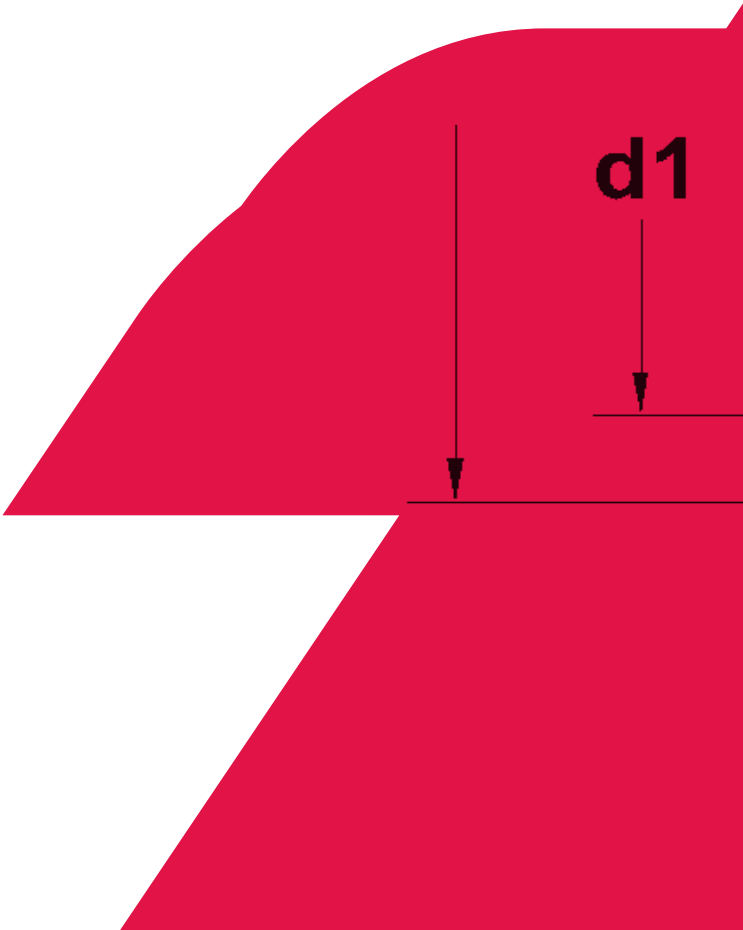

d1

D3

d3

“Apollo”® Press
fittings

l3

z3

z2

z1

l1

l2

90° elbows

807 | 807R 90° elbow | small diameter
(press x press)

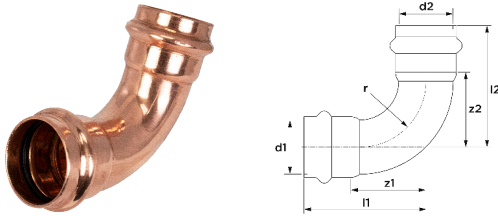

807

item no.	size	d1	d2	l1	l2	z1	z2
10075554	½"	0.63	0.63	1.53	1.53	0.72	0.72
10075556	¾"	0.88	0.88	1.98	1.98	0.98	0.98
10077680	1"	1.13	1.13	2.25	2.25	1.44	1.44
10077658	1¼"	1.38	1.38	2.69	2.69	1.66	1.66
10075080	1½"	1.63	1.63	3.41	3.41	1.94	1.94
10075082	2"	2.13	2.13	4.10	4.10	2.43	2.43

807R

item no.	size	d1	d2	l1	l2	z1	z2
10066101	¾" x ½"	0.88	0.63	1.96	3.11	1.04	2.26
10066083	1" x ¾"	1.13	0.88	2.23	3.53	1.31	2.68

807L 90° elbow long radius | large diameter
(press x press)

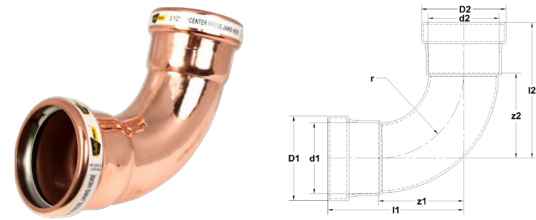

item no.	size	d1	d2	l1	l2	z1	z2
10062066	2½"	2.63	2.63	5.09	5.09	3.19	3.19
10012067	3"	3.13	3.13	5.93	5.93	3.83	3.83
10062069	4"	4.13	4.13	7.40	7.40	4.90	4.90

807-2 90° street elbow | small diameter
(press x FTG)

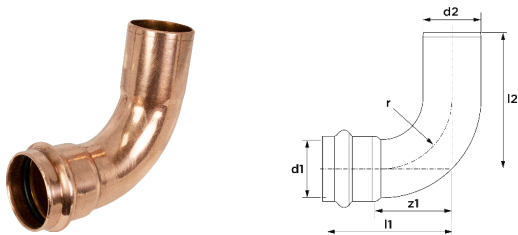

item no.	size	d1	d2	l1	l2	z1
10015566	½"	0.63	0.63	1.50	1.93	0.75
10075044	¾"	0.88	0.88	1.99	2.26	1.07
10015046	1"	1.13	1.13	2.21	2.72	1.26
10015072	1¼"	1.38	1.38	2.56	2.90	1.54
10075074	1½"	1.63	1.63	3.39	3.46	1.96
10015076	2"	2.13	2.13	4.08	4.21	2.50

807L-2 90° elbow long radius | large diameter
(press x FTG)

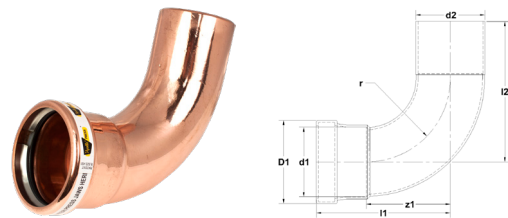

item no.	size	d1	d2	l1	l2	z1
10062071	2½"	2.63	2.63	5.09	5.27	3.85
10012073	3"	3.13	3.13	5.95	6.12	3.85
10012074	4"	4.13	4.13	7.57	7.78	5.07

8707-3 | 8707R-3 female 90° elbow | small diameter
(press x FPT)

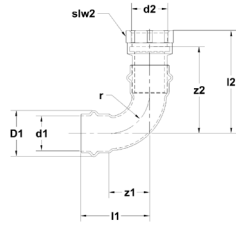

8707-3

item no.	size	d1	d2	l1	l2	z1	z2
10066560	½" x FPT ½"	0.63	0.84	1.50	2.44	0.75	2.04
10066561	¾" x FPT ¾"	0.88	1.05	1.96	2.92	1.04	2.50
10066562	1" x FPT 1"	1.13	1.32	2.23	3.33	1.31	2.81
10066563	1¼" x FPT 1¼"	1.38	1.66	2.96	4.04	1.87	3.49
10066564	1½" x FPT 1½"	1.63	1.90	3.32	4.04	2.02	3.51
10066565	2" x FPT 2"	2.13	2.38	4.11	5.32	2.52	4.76

8707R-3

item no.	size	d1	d2	l1	l2	z1	z2
10066566	½" x FPT ¾"	0.63	0.68	1.50	2.29	0.75	1.68
10066567	½" x FPT ¾"	0.63	1.05	1.50	2.52	0.75	2.10
10066568	¾" x FPT ½"	0.88	0.84	1.96	2.85	1.04	2.45
10066569	1" x FPT ½"	1.13	0.84	2.23	2.95	1.31	2.55

8707-3-5 | 8707R-3-5 drop-ear 90° elbow | small diameter
(press x FPT)

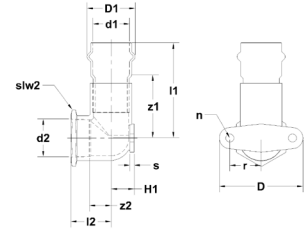

8707-3-5

item no.	size	d1	d2	l1	l2	z1	z2	n	r	D	H1
10075366	½" x FPT ½"	0.63	0.84	2.11	0.77	1.27	0.38	0.18	0.75	2.10	0.40
10075368	¾" x FPT ¾"	0.88	1.05	2.66	0.91	1.74	0.43	0.18	0.75	2.10	0.61

8707R-3-5

item no.	size	d1	d2	l1	l2	z1	z2	n	r	D	H1
10075367	½" x FPT ¾"	0.63	0.68	2.06	0.71	1.21	0.36	0.18	0.75	2.10	0.41

“Apollo”® Press

45° elbows

806 45° elbow | small diameter (press x press)

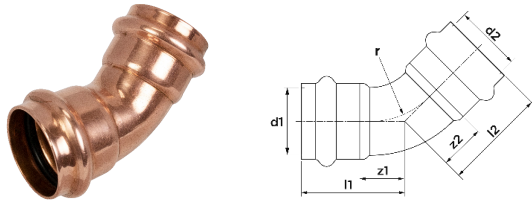

item no.	size	d1	d2	l1	l2	z1	z2
10077682	½"	0.63	0.63	1.05	1.05	0.26	0.26
10077672	¾"	0.88	0.88	1.27	1.27	0.36	0.36
10077674	1"	1.13	1.13	1.46	1.46	0.53	0.53
10077652	1¼"	1.38	1.38	1.54	1.54	0.26	0.26
10077654	1½"	1.63	1.63	2.12	2.12	1.10	1.10
10015094	2"	2.13	2.13	2.58	2.58	0.93	0.93

806 45° elbow | large diameter (press x press)

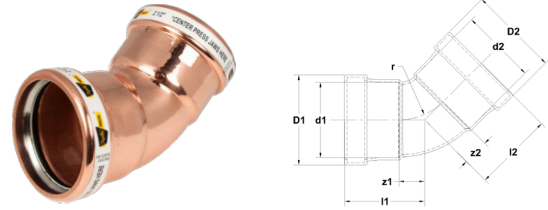

item no.	size	d1	d2	l1	l2	z1	z2
10012052	2½"	2.63	2.63	3.36	3.36	1.46	1.46
10012057	3"	3.13	3.13	3.81	3.81	1.71	1.71
10012062	4"	4.13	4.13	4.68	4.68	2.18	2.18

806-2 45° street elbow | small diameter (press x FTG)

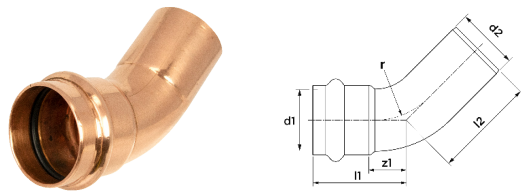

item no.	size	d1	d2	l1	l2	z1
10015054	½"	0.63	0.63	1.15	1.31	0.34
10015056	¾"	0.88	0.88	1.39	1.36	0.37
10015058	1"	1.13	1.13	1.55	1.52	0.56
10015084	1¼"	1.38	1.38	1.52	1.70	0.59
10075086	1½"	1.63	1.63	2.32	2.71	0.78
10015088	2"	2.13	2.13	2.63	2.71	1.05

806-2 45° street elbow | large diameter (press x FTG)

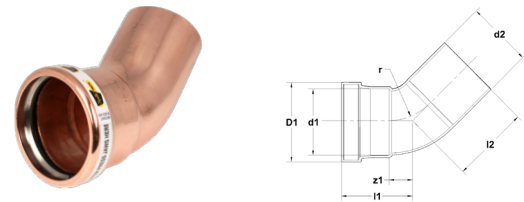

item no.	size	d1	d2	l1	l2	z1
10062037	2½"	2.63	2.63	2.81	3.16	0.91
10012042	3"	3.13	3.13	3.81	3.95	1.71
10012047	4"	4.13	4.13	4.92	4.93	2.42

811 | 811R | 811BH tee | small diameter
(press x press x press)

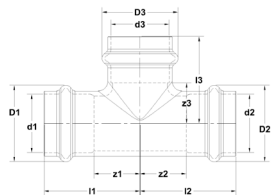

item no.	size	d1	d2	d3	l1	l2	l3	z1	z2	z3
10017739	½"	0.63	0.63	0.63	1.49	1.49	1.35	0.71	0.71	0.57
10017740	¾"	0.88	0.88	0.88	1.73	1.73	1.61	0.78	0.78	0.62
10017741	1"	1.13	1.13	1.13	1.81	1.81	1.77	0.90	0.90	0.83
10017742	1¼"	1.38	1.38	1.38	2.06	2.06	1.96	1.00	1.00	0.89
10017743	1½"	1.63	1.63	1.63	2.58	2.58	2.57	1.11	1.11	1.10
10017744	2"	2.13	2.13	2.13	2.98	2.98	3.01	1.33	1.33	1.41

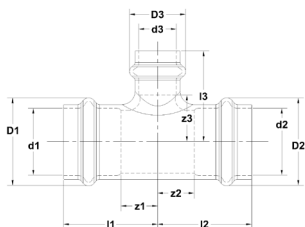

reducing

item no.	size	d1	d2	d3	l1	l2	l3	z1	z2	z3
10077810	½" x ½" x ¾"	0.63	0.63	0.88	1.69	1.69	1.50	0.97	0.97	0.62
10017784	¾" x ½" x ½"	0.88	0.63	0.63	1.58	1.75	1.39	0.62	0.97	0.62
10077785	¾" x ½" x ¾"	0.88	0.63	0.88	1.77	1.89	1.52	0.81	1.12	0.54
10017745	¾" x ¾" x ½"	0.88	0.88	0.63	1.60	1.60	1.38	0.65	0.65	0.59
10066071	¾" x ¾" x 1"	0.88	0.88	1.13	3.33	3.33	1.75	2.39	2.39	0.80
10077786	1" x ½" x ¾"	1.13	0.63	0.88	1.75	2.00	1.64	0.78	1.21	0.70
10077787	1" x ½" x 1"	1.13	0.63	1.13	1.85	2.31	1.71	0.91	1.55	0.77
10077788	1" x ¾" x ½"	1.13	0.88	0.63	1.59	1.85	1.56	0.59	1.07	0.79
10077789	1" x ¾" x ¾"	1.13	0.88	0.88	1.72	2.00	1.66	0.71	1.00	0.75
10077790	1" x ¾" x 1"	1.13	0.88	1.13	1.82	1.14	1.70	0.85	0.22	0.79
10017746	1" x 1" x ½"	1.13	1.13	0.63	1.61	1.61	1.55	0.66	0.66	0.80
10017747	1" x 1" x ¾"	1.13	1.13	0.88	1.80	1.80	1.66	0.89	0.89	0.70
10077791	1¼" x ½" x 1¼"	1.38	0.63	1.38	2.06	2.49	1.90	0.98	1.77	0.82
10077792	1¼" x ¾" x ¾"	1.38	0.88	0.88	1.75	2.20	1.76	0.64	1.29	0.87
10077793	1¼" x ¾" x 1"	1.38	0.88	1.13	1.91	2.30	1.80	0.88	1.40	0.90
10077794	1¼" x ¾" x 1¼"	1.38	0.88	1.38	2.01	2.46	1.91	0.93	1.54	0.82
10077795	1¼" x 1" x ½"	1.38	1.13	0.63	1.67	1.77	1.68	0.59	0.86	0.87
10077796	1¼" x 1" x ¾"	1.38	1.13	0.88	1.81	2.00	1.77	0.78	1.12	0.82
10077797	1¼" x 1" x 1"	1.38	1.13	1.13	1.93	2.12	1.81	0.90	1.23	0.91
10077748	1¼" x 1¼" x ½"	1.38	1.38	0.63	1.69	1.69	1.70	0.60	0.60	0.87
10077749	1¼" x 1¼" x ¾"	1.38	1.38	0.88	1.80	1.80	1.81	0.74	0.74	0.85
10077750	1¼" x 1¼" x 1"	1.38	1.38	1.13	1.91	1.91	1.80	0.81	0.81	0.90
10066397	1½" x ¾" x 1"	1.63	0.88	1.13	2.21	3.93	2.14	0.77	3.05	1.19
10077798	1½" x 1" x ¾"	1.63	1.13	0.88	2.11	2.28	2.06	0.58	1.35	1.07
10077799	1½" x 1" x 1"	1.63	1.13	1.13	2.22	2.38	1.96	0.81	1.46	1.05
10066081	1½" x 1" x 1¼"	1.63	1.13	1.38	3.12	3.34	2.14	1.64	2.34	0.83

note continuation on the next page

tees

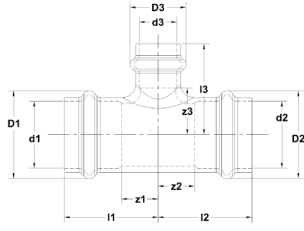

item no.	size	d1	d2	d3	l1	l2	l3	z1	z2	z3
10077800	1½" x 1" x 1½"	1.63	1.13	1.63	2.56	2.69	2.56	1.13	1.55	1.13
10077801	1½" x 1¼" x ¾"	1.63	1.38	0.88	2.10	2.12	2.06	0.62	1.09	1.16
10077802	1½" x 1¼" x 1"	1.63	1.38	1.13	2.23	2.33	2.09	0.81	1.31	1.08
10077803	1½" x 1¼" x 1¼"	1.63	1.38	1.38	2.30	2.38	2.18	0.83	1.33	1.09
10077751	1½" x 1½" x ½"	1.63	1.63	0.63	1.92	1.92	1.87	0.40	0.40	1.08
10077752	1½" x 1½" x ¾"	1.63	1.63	0.88	2.10	2.10	2.06	0.64	0.64	1.13
10077753	1½" x 1½" x 1"	1.63	1.63	1.13	2.19	2.19	2.15	0.77	0.77	1.20
10077754	1½" x 1½" x 1¼"	1.63	1.63	1.38	2.29	2.29	2.14	0.91	0.91	1.27
10066090	1½" x 1½" x 2"	1.63	1.63	2.13	5.10	5.10	3.01	3.71	3.71	1.34
10066397	1½" x ¾" x 1"	1.63	0.88	1.13	2.21	3.93	2.14	0.77	3.05	1.19
10066018	2" x 1" x 2"	2.13	1.13	2.13	2.99	5.10	3.00	1.38	4.11	1.37
10066197	2" x 1" x 1½"	2.13	1.13	1.65	2.71	4.85	2.81	1.06	3.90	1.27
10077804	2" x 1¼" x 1¼"	2.13	1.38	1.38	2.52	2.87	2.35	0.94	1.84	1.33
10066125	2" x 1¼" x 1½"	2.13	1.38	1.63	2.72	4.56	2.75	1.09	3.50	1.24
10066064	2" x 1¼" x 2"	2.13	1.38	2.13	2.95	4.71	2.95	1.37	3.67	1.37
10077806	2" x 1½" x 1"	2.13	1.63	1.13	2.40	2.38	2.28	0.77	1.47	1.32
10077807	2" x 1½" x 1¼"	2.13	1.63	1.38	2.53	2.94	2.50	0.92	1.49	1.41
10077808	2" x 1½" x 1½"	2.13	1.63	1.63	2.67	3.08	2.76	1.10	1.68	1.33
10077809	2" x 1½" x 2"	2.13	1.63	2.13	3.53	2.94	2.94	1.96	1.46	1.35
10077755	2" x 2" x ½"	2.13	2.13	0.63	2.12	2.12	2.07	0.53	0.53	1.24
10077756	2" x 2" x ¾"	2.13	2.13	0.88	2.38	2.38	2.19	0.75	0.75	1.30
10077757	2" x 2" x 1"	2.13	2.13	1.13	2.45	2.45	2.28	0.90	0.90	1.44
10077758	2" x 2" x 1¼"	2.13	2.13	1.38	2.64	2.64	2.44	1.07	1.07	1.41
10077759	2" x 2" x 1½"	2.13	2.13	1.63	2.70	2.70	2.80	1.16	1.16	1.33
10077805	2" x 1½" x ¾"	2.13	1.63	0.88	2.29	2.75	2.29	0.69	1.36	1.35

811 | 811R tee | large diameter
(press x press x press)

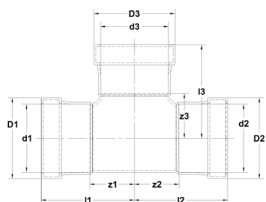

item no.	size	d1	d2	d3	l1	l2	l3	z1	z2	z3
10017760	2½"	2.63	2.63	2.63	3.66	3.66	3.84	1.76	1.76	1.94
10017761	3"	3.13	3.13	3.13	4.07	4.07	4.31	1.97	1.97	2.21
10017762	4"	4.13	4.13	4.13	4.97	4.97	5.22	2.47	2.47	2.72

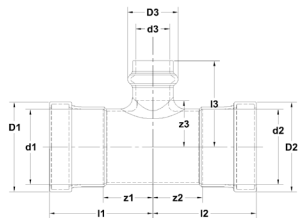

reducing

item no.	size	d1	d2	d3	l1	l2	l3	z1	z2	z3
10077763	2½" x 2½" x ½"	2.63	2.63	0.63	2.81	2.81	2.81	0.91	0.91	0.91
10017764	2½" x 2½" x ¾"	2.63	2.63	0.88	3.02	3.02	2.47	1.12	1.12	1.58
10077765	2½" x 2½" x 1"	2.63	2.63	1.13	2.94	2.94	2.74	1.04	1.04	1.77
10077766	2½" x 2½" x 1¼"	2.63	2.63	1.38	3.06	3.06	2.85	1.16	1.16	1.76
10017767	2½" x 2½" x 1½"	2.63	2.63	1.63	3.34	3.34	3.09	1.44	1.44	1.78
10077768	2½" x 2½" x 2"	2.63	2.63	2.14	3.44	3.44	3.34	1.54	1.54	1.75
10066604	3" x 2" x 2"	3.13	2.14	2.14	3.66	6.16	3.58	1.56	4.65	1.99
10066136	3" x 2½" x 2½"	3.13	2.63	2.63	4.03	6.93	4.31	1.92	4.98	2.33
10017769	3" x 3" x ½"	3.13	3.13	0.63	3.20	3.20	2.61	1.18	1.18	1.76
10077770	3" x 3" x ¾"	3.13	3.13	0.88	3.03	3.03	2.69	0.93	0.93	1.80
10077771	3" x 3" x 1"	3.13	3.13	1.13	3.16	3.16	2.99	1.06	1.06	2.02
10077772	3" x 3" x 1¼"	3.13	3.13	1.38	3.28	3.28	3.10	1.18	1.18	2.01
10017773	3" x 3" x 1½"	3.13	3.13	1.63	3.61	3.61	3.34	1.51	1.51	2.03
10017774	3" x 3" x 2"	3.13	3.13	2.13	3.77	3.77	3.59	1.67	1.67	2.00
10077775	3" x 3" x 2½"	3.13	3.13	2.62	3.95	3.95	4.05	1.85	1.85	2.15
10077776	4" x 4" x ½"	4.13	4.13	0.63	3.58	3.58	3.09	1.08	1.08	2.24
10017777	4" x 4" x ¾"	4.13	4.13	0.88	3.80	3.80	3.21	1.30	1.30	2.32
10077778	4" x 4" x 1"	4.13	4.13	1.13	3.86	3.86	3.49	1.36	1.36	2.52
10077779	4" x 4" x 1¼"	4.13	4.13	1.38	3.86	3.86	3.59	1.36	1.36	2.50
10017780	4" x 4" x 1½"	4.13	4.13	1.63	4.06	4.06	3.83	1.56	1.56	2.52
10077781	4" x 4" x 2"	4.13	4.13	2.13	4.09	4.09	4.12	1.59	1.59	2.53
10077782	4" x 4" x 2½"	4.13	4.13	2.63	4.39	4.39	4.55	1.89	1.89	2.65
10077783	4" x 4" x 3"	4.13	4.13	3.13	4.61	4.61	4.79	2.11	2.11	2.69

“Apollo”® Press

tees

8712 | 8712R female tee | small diameter (press x press x press)

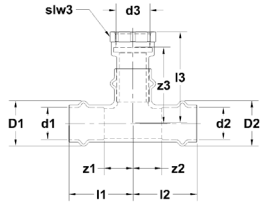

item no.	size	d1	d2	d3	l1	l2	l3	z1	z2	z3
10066579	½" x ½" x FPT ½"	0.63	0.63	0.84	1.50	1.50	2.21	0.75	0.75	1.81
10066580	¾" x ¾" x FPT ¾"	0.88	0.88	1.05	1.74	1.74	2.65	0.72	0.72	2.10

reducing

item no.	size	d1	d2	d3	l1	l2	l3	z1	z2	z3
10066581	¾" x ¾" x FPT ½"	0.88	0.88	0.84	1.60	1.60	2.51	0.65	0.65	1.95
10066582	1" x 1" x FPT ½"	1.13	1.13	0.84	1.61	1.61	2.64	0.69	0.69	2.08
10066583	1" x 1" x FPT ¾"	1.13	1.13	1.05	1.75	1.75	2.80	0.78	0.78	2.25
10066584	1¼" x 1¼" x FPT ½"	1.38	1.38	0.84	1.68	1.68	2.81	0.61	0.61	2.26
10066585	1¼" x 1¼" x FPT ¾"	1.38	1.38	1.05	1.82	1.82	2.95	0.81	0.81	2.40
10066586	1½" x 1½" x FPT ½"	1.63	1.63	0.84	1.93	1.93	3.07	0.43	0.43	2.53
10066587	1½" x 1½" x FPT ¾"	1.63	1.63	1.05	2.09	2.09	3.18	0.63	0.63	2.64
10066588	2" x 2" x FPT ½"	2.13	2.13	0.84	2.16	2.16	3.18	0.53	0.53	2.63
10066589	2" x 2" x FPT ¾"	2.13	2.13	1.05	2.37	2.37	3.27	0.71	0.71	2.72

800 coupling | small diameter
(press x press)

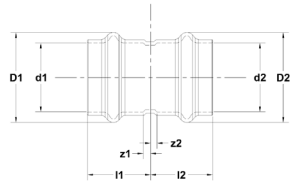

item no.	size	d1	d2	l1	l2	z1	z2
10075500	½"	0.63	0.63	0.81	0.81	0.05	0.05
10077693	¾"	0.88	0.88	0.98	0.98	0.03	0.03
10075504	1"	1.13	1.13	0.98	0.98	0.05	0.05
10077698	1¼"	1.38	1.38	1.10	1.10	0.06	0.06
10077699	1½"	1.63	1.63	1.50	1.50	0.07	0.07
10077000	2"	2.13	2.13	1.65	1.65	0.07	0.07

800 coupling | large diameter
(press x press)

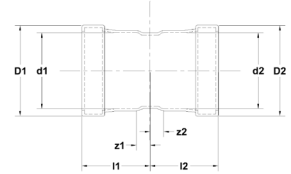

item no.	size	d1	d2	l1	l2	z1	z2
10077701	2½"	2.63	2.63	2.38	2.38	0.48	0.48
10077702	3"	3.13	3.13	2.59	2.59	0.49	0.49
10077703	4"	4.13	4.13	3.03	3.03	0.53	0.53

801L no stop (extended) coupling | small diameter
(press x press)

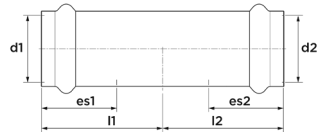
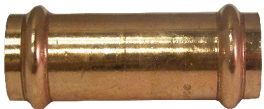

item no.	size	d1	d2	l1	l2	es1	es2
10075030	½"	0.63	0.63	1.64	1.64	0.81	0.81
10075032	¾"	0.88	0.88	1.49	1.49	0.88	0.88
10075034	1"	1.13	1.13	1.78	1.78	0.92	0.92

couplings

801 | 801R coupling | small diameter
(press x press)

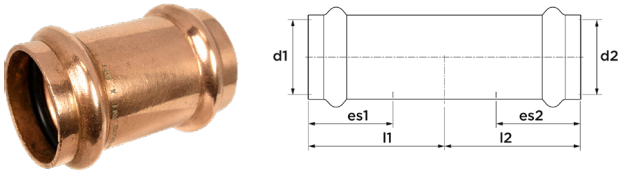

item no.	size	d1	d2	l1	l2	es1	es2
10077691	½"	0.63	0.63	0.81	0.81	0.06	0.06
10077694	¾"	0.88	0.88	0.97	0.97	0.06	0.06
10075517	1"	1.13	1.13	0.97	0.97	0.08	0.08
10077695	1¼"	1.38	1.38	1.10	1.10	0.07	0.07
10077696	1½"	1.63	1.63	1.50	1.50	0.07	0.07
10077697	2"	2.13	2.13	1.66	1.66	0.07	0.07

801 | 801R no stop coupling | large diameter
(press x press)

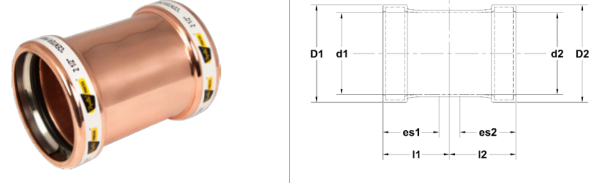

item no.	size	d1	d2	l1	l2	es1	es2
10061932	2½"	2.63	2.63	2.17	2.17	1.90	1.90
10061937	3"	3.13	3.13	2.33	2.33	1.90	1.90
10061942	4"	4.13	4.13	2.77	2.77	2.10	2.10

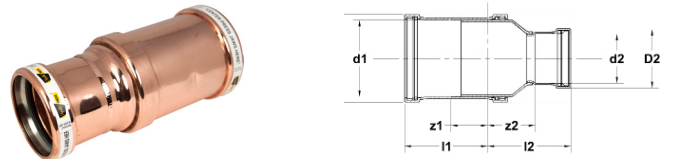

reducing

item no.	size	d1	d2	l1	l2	z1	z2
10066440	2½" x 1"	2.63	1.13	4.29	3.22	2.29	2.29
10066074	2½" x 2"	2.63	2.13	3.88	3.51	1.88	1.88
10066446	3" x 2"	3.13	2.13	4.15	3.60	1.96	1.96
10066076	3" x 2½"	3.13	2.63	4.03	3.79	1.85	1.85
10066447	4" x 2"	4.13	2.13	5.01	4.27	2.52	2.52
10066152	4" x 3"	4.13	3.13	4.75	4.75	2.25	2.65

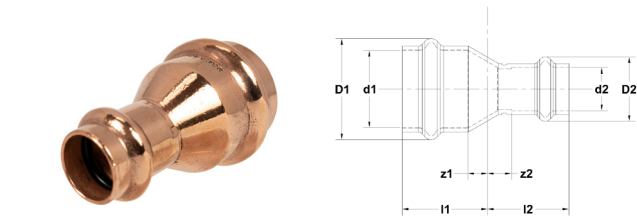

reducing

item no.	size	d1	d2	l1	l2	z1	z2
10015900	¾" x ½"	0.88	0.63	1.04	1.04	0.13	0.23
10075144	1" x ½"	1.13	0.63	1.41	0.90	0.42	0.05
10015898	1" x ¾"	1.13	0.88	1.13	1.13	0.16	0.18
10066001	1¼" x ¾"	1.38	0.88	1.98	1.96	0.98	0.98
10015896	1¼" x 1"	1.38	1.13	1.25	1.25	0.15	0.32
10066380	1½" x ½"	1.63	0.63	2.71	2.20	1.27	1.27
10066381	1½" x ¾"	1.63	0.88	2.65	2.17	1.19	1.19
10066003	1½" x 1"	1.63	1.13	2.61	2.16	1.16	1.16
10075128	1½" x 1¼"	1.63	1.38	1.65	1.32	0.35	0.28
10066398	2" x ¾"	2.13	0.88	3.21	2.54	1.58	1.58
10066005	2" x 1"	2.13	1.13	3.05	2.42	1.41	1.41
10066072	2" x 1¼"	2.13	1.38	2.89	2.31	1.25	1.25
10075130	2" x 1½"	2.13	1.63	1.84	1.74	0.43	0.43

818 fitting reducer | small diameter
(FTG x press)

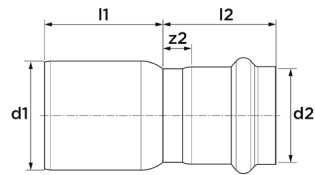

item no.	size	d1	d2	l1	l2	z2
10075146	Ø¼" x ½"	0.88	0.63	1.12	1.04	0.29
10075150	Ø1" x ½"	1.13	0.63	1.43	1.00	0.14
10075148	Ø1" x ¾"	1.13	0.88	1.28	1.12	0.22
10075336	Ø1¼" x ½"	1.38	0.63	1.85	1.02	0.08
10075154	Ø1¼" x ¾"	1.38	0.88	1.61	1.11	0.18
10075156	Ø1¼" x 1"	1.38	1.13	1.45	1.11	0.10
10075334	Ø1½" x ¾"	1.63	0.88	2.25	1.10	0.19
10075158	Ø1½" x 1"	1.63	1.13	2.05	1.20	0.20
10075160	Ø1½" x 1¼"	1.63	1.38	1.52	1.31	0.22
10075338	Ø2" x ½"	2.13	0.63	2.99	1.00	0.19
10075340	Ø2" x ¾"	2.13	0.88	2.76	1.18	0.27
10075162	Ø2" x 1"	2.13	1.13	2.60	1.16	0.17
10075332	Ø1 1/2" x 1/2"	1.63	0.63	2.29	1.03	0.19
10075152	Ø2" x 1¼"	2.13	1.38	2.29	1.24	0.19
10075164	Ø2" x 1½"	2.13	1.63	1.80	1.60	0.23

818 fitting reducer | large diameter
(FTG x press)

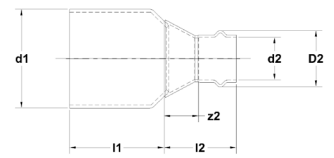

item no.	size	d1	d2	l1	l2	z2
10018001	Ø2½" x ¾"	2.63	0.88	2.79	1.54	0.65
10068002	Ø2½" x 1"	2.63	1.13	2.88	1.71	0.74
10068017	Ø2½" x 1¼"	2.63	1.38	2.67	1.57	0.53
10068004	Ø2½" x 1½"	2.63	1.63	2.54	1.71	0.40
10075165	Ø2½" x 2"	2.63	2.13	2.57	1.79	0.28
10068019	Ø3" x ¾"	3.13	0.88	3.10	1.72	0.83
10068008	Ø3" x 1¼"	3.13	1.38	2.88	1.65	0.61
10068020	Ø3" x 1½"	3.13	1.63	2.75	1.79	0.48
10018010	Ø3" x 2"	3.13	2.13	2.81	2.06	0.55
10057500	Ø3" x 2½"	3.13	2.63	2.85	2.24	0.34
10068022	Ø4" x ¾"	4.13	0.88	3.89	1.98	1.09
10068016	Ø4" x 2"	4.13	2.13	3.45	2.20	0.69
10057503	Ø4" x 2½"	4.13	2.63	3.32	2.55	0.65
10057506	Ø4" x 3"	4.13	3.13	3.23	2.68	0.58

adapters

803 | 803R female adapter | small diameter
(FPT x press)

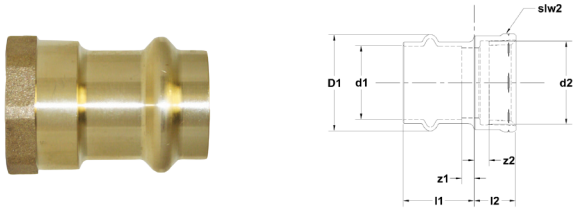

item no.	size	d1	d2	l1	l2	z1	z2
10075750	½" x FPT ½"	0.63	0.84	0.84	0.85	0.15	0.15
10075752	¾" x FPT ¾"	0.88	1.05	1.07	0.67	0.07	0.07
10075754	1" x FPT 1"	1.13	1.32	1.13	0.80	0.06	0.06
10075756	1¼" x FPT 1¼"	1.38	1.66	1.26	0.64	0.13	0.13
10075758	1½" x FPT 1½"	1.63	1.90	1.56	0.87	0.13	0.13
10075760	2" x FPT 2"	2.13	2.38	1.75	0.86	0.12	0.12

reducing

item no.	size	d1	d2	l1	l2	z1	z2
10075780	½" x FPT ¾"	0.63	0.68	0.90	0.44	0.14	0.14
10075782	½" x FPT ¾"	0.63	1.05	0.98	0.64	0.22	0.22
10075784	¾" x FPT ½"	0.88	0.84	1.01	0.49	0.09	0.09
10075796	1" x FPT ½"	1.13	0.84	1.03	0.52	0.12	0.12
10075798	1" x FPT ¾"	1.13	1.05	1.04	0.52	0.12	0.12
10075800	1" x FPT 1¼"	1.13	1.66	1.17	0.79	0.25	0.25
10075786	1¼" x FPT ½"	1.38	0.84	1.15	0.50	0.10	0.10
10075788	1¼" x FPT 1"	1.38	1.32	1.16	0.64	0.12	0.12
10075790	1¼" x FPT 1½"	1.38	1.90	1.24	0.74	0.20	0.20
10075792	1½" x FPT ¾"	1.63	1.05	1.53	0.50	0.10	0.10
10075794	1½" x FPT 1¼"	1.63	1.66	1.54	0.65	0.11	0.11

803-2 | 803R-2 female street adapter | small diameter
(FTG x FPT)

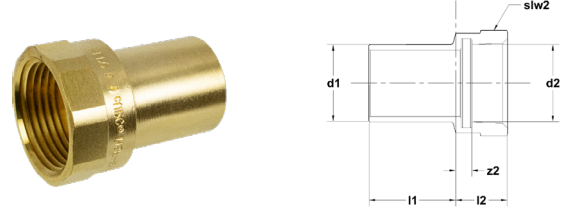

item no.	size	d1	d2	l1	l2	z1
10075762	½" x FPT ½"	0.63	0.84	1.26	0.59	0.18
10075768	¾" x FPT ¾"	0.88	1.05	1.35	0.65	0.23
10075772	1" x FPT 1"	1.13	1.32	1.27	0.76	0.24
10075774	1¼" x FPT 1¼"	1.38	1.66	1.41	0.78	0.25
10075776	1½" x FPT 1½"	1.63	1.90	1.78	0.79	0.23
10075778	2" x FPT 2"	2.13	2.38	1.96	0.82	0.22

reducing

item no.	size	d1	d2	l1	l2	z1
10075764	½" x FPT ¾"	0.63	0.68	1.08	0.58	0.18
10075766	½" x FPT ¾"	0.63	1.05	1.12	0.69	0.23
10075770	¾" x FPT ½"	0.88	0.84	1.30	0.54	0.14
10075804	1" x FPT ½"	1.13	0.84	1.20	0.45	0.05
10075802	1¼" x FPT ½"	1.38	0.84	1.32	0.55	0.15

804 | 804R male adapter | small diameter
(press x MPT)

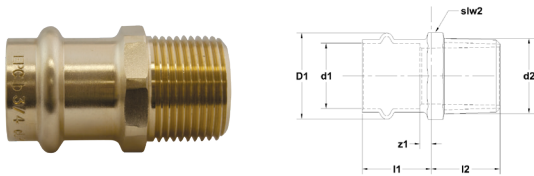

item no.	size	d1	d2	l1	l2	z1
10075806	½" x MPT ½"	0.63	0.84	1.08	0.84	0.22
10075808	¾" x MPT ¾"	0.88	1.05	1.30	0.85	0.11
10075844	1" x MPT 1"	1.13	1.32	1.24	1.15	0.25
10075810	1¼" x MPT 1¼"	1.38	1.66	1.37	1.02	0.31
10075812	1½" x MPT 1½"	1.63	1.90	1.66	1.02	0.22
10075814	2" x MPT 2"	2.13	2.38	1.87	1.10	0.25

reducing

item no.	size	d1	d2	l1	l2	z1
10075836	½" x MPT ¾"	0.63	0.68	1.24	0.55	0.49
10075838	½" x MPT ¾"	0.63	1.05	1.17	0.69	0.42
10075840	¾" x MPT ½"	0.88	0.84	1.59	0.62	0.68
10075842	¾" x MPT 1"	0.88	1.32	1.61	0.79	0.70
10075854	1" x MPT ¾"	1.13	1.05	1.43	0.81	0.52
10075856	1" x MPT 1¼"	1.13	1.66	1.41	1.03	0.50
10075846	1¼" x MPT 1"	1.38	1.32	1.40	1.02	0.36
10075848	1¼" x MPT 1½"	1.38	1.90	1.61	1.01	0.56
10075850	1½" x MPT 1¼"	1.63	1.66	1.73	1.00	0.30
10075852	1½" x MPT 2"	1.63	2.38	1.95	0.90	0.52
10075858	2" x MPT 1½"	2.13	1.90	2.08	1.03	0.49

804 male adapter | large diameter
(press x MPT)

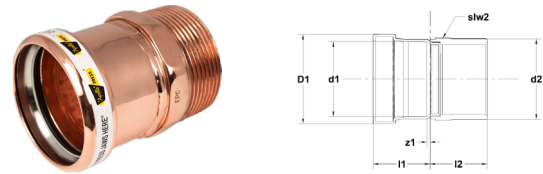

item no.	size	d1	d2	l1	l2	z1
10011982	2½" x MPT 2½"	2.63	2.88	2.40	1.64	0.50
10061987	3" x MPT 3"	3.13	3.50	2.60	1.70	0.50
10011992	4" x MPT 4"	4.13	4.50	3.01	2.11	0.51

804-2 | 804R-2 male street adapter | small diameter
(FTG x MPT)

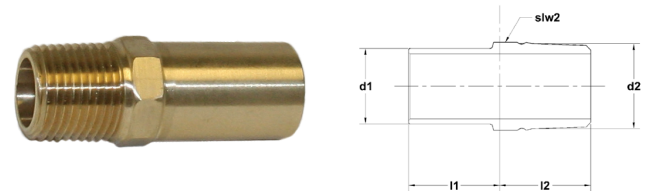

item no.	size	d1	d2	l1	l2	slw2
10075816	½" x MPT ½"	0.63	0.84	1.24	1.14	-
10075822	¾" x MPT ¾"	0.88	1.05	1.26	1.15	-
10075826	1" x MPT 1"	1.13	1.32	1.26	1.24	-
10075828	1¼" x MPT 1¼"	1.38	1.66	1.32	1.28	-
10075830	1½" x MPT 1½"	1.63	1.90	1.77	1.51	-
10075834	2" x MPT 2"	2.13	2.38	1.90	1.56	-

reducing

item no.	size	d1	d2	l1	l2
10075818	½" x MPT ¾"	0.63	0.68	1.07	0.92
10075820	½" x MPT ¾"	0.63	1.05	1.28	1.14
10075824	¾" x MPT ½"	0.88	0.84	1.23	1.08
10075832	1" x MPT ¾"	1.13	1.05	1.29	1.26

“Apollo”® Press

flange adapters

8771 male adapter | large diameter (press x flange) | ANSI class 150

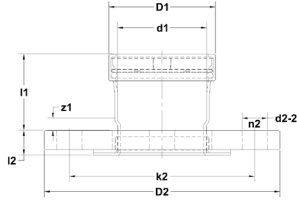
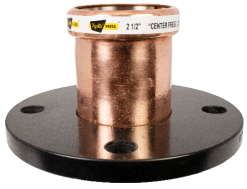

item no.	size	d1	n2	k2	l1	l2	z1
10061763	2½"	2.63	4	0.75	2.74	0.88	0.84
10061769	3"	3.13	4	0.75	2.81	0.94	0.71
10061738	4"	4.13	8	0.75	2.88	0.94	0.38

8733 union | small diameter
(press x press)

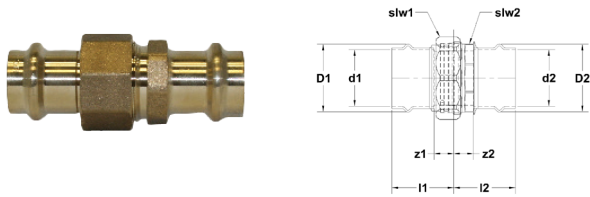

item no.	size	d1	d2	l1	l2	z1	z2
10075860	½"	0.63	0.63	1.48	1.48	0.72	0.72
10075862	¾"	0.88	0.88	1.79	1.79	0.87	0.87
10075864	1"	1.13	1.13	1.90	1.90	0.98	0.98
10075866	1¼"	1.38	1.38	1.89	1.89	0.85	0.85
10075868	1½"	1.63	1.63	1.96	1.96	0.53	0.53
10075870	2"	2.13	2.13	2.32	2.32	0.74	0.74

8733-3 female union | small diameter
(press x FPT)

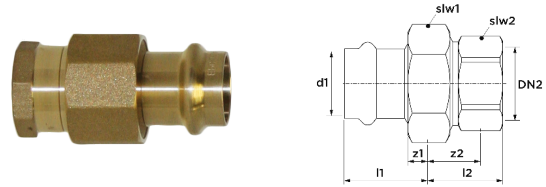

item no.	size	d1	DN2	l1	l2	z1	z2
10075872	½" x FPT ½"	0.63	0.84	1.38	0.72	0.62	0.32
10075874	¾" x FPT ¾"	0.88	1.05	1.73	1.11	0.81	0.69
10075876	1" x FPT 1"	1.13	1.32	1.80	1.04	0.89	0.52
10075878	1¼" x FPT 1¼"	1.38	1.66	1.80	1.32	0.76	0.78
10075880	1½" x FPT 1½"	1.63	1.90	1.75	1.30	0.32	0.79
10075882	2" x FPT 2"	2.13	2.38	2.13	1.17	0.55	0.62

8733-4 male union | small diameter
(press x MPT)

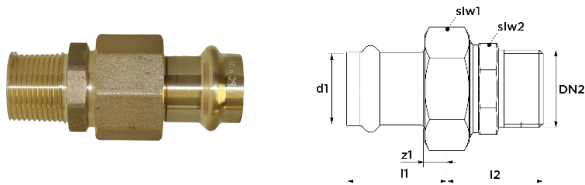

item no.	size	d1	DN2	l1	l2	z1
10075884	½" x MPT ½"	0.63	0.84	1.38	1.48	0.62
10075886	¾" x MPT ¾"	0.88	1.05	1.73	1.65	0.81
10075888	1" x MPT 1"	1.13	1.32	1.80	1.91	0.89
10075890	1¼" x MPT 1¼"	1.38	1.66	1.82	1.97	0.77
10075892	1½" x MPT 1½"	1.63	1.90	1.75	1.94	0.32
10075894	2" x MPT 2"	2.13	2.38	2.13	2.06	0.55

8734 female dielectric union | small diameter
(press x FPT)

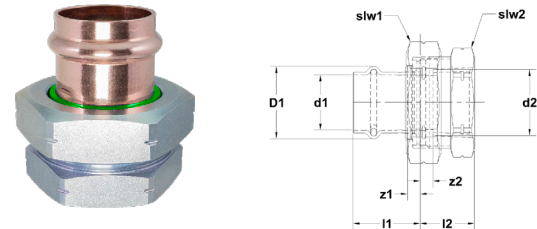

item no.	size	d1	d2	l1	l2	z1	z2
10077914	½" x FPT ½"	0.63	0.84	1.22	0.97	0.47	0.47
10077920	¾" x FPT ¾"	0.88	1.05	1.32	0.98	0.41	0.41
10077926	1" x FPT 1"	1.13	1.32	1.33	1.11	0.42	0.42
10077932	1¼" x FPT 1¼"	1.38	1.66	1.52	1.17	0.49	0.49
10077938	1½" x FPT 1½"	1.63	1.90	1.91	1.17	0.48	0.48
10077944	2" x FPT 2"	2.13	2.38	2.09	1.26	0.51	0.51

caps

817 tube cap | small diameter
(press x cap)

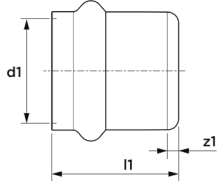

item no.	size	d1	l1	z1
10017850	½"	0.63	0.93	0.06
10017851	¾"	0.88	1.05	0.08
10017852	1"	1.13	1.04	0.10
10015172	1¼"	1.38	1.36	0.22
1005174	1½"	1.63	1.63	0.20
10015176	2"	2.13	1.82	0.24

817 tube cap | large diameter
(press x cap)

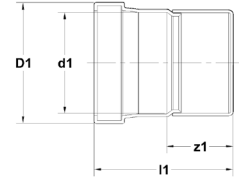

item no.	size	d1	l1	z1
10062142	2½"	2.63	3.64	1.90
10062147	3"	3.13	4.07	2.10
10012152	4"	4.13	4.24	1.78

more information?

For a complete and up-to-date product range and our additional services, visit: aalberts-ips.us

Would you like to make an appointment to meet an account manager in your region or receive advice and support from one of our experts?

Please contact:

Aalberts integrated piping systems customer service

704.841.6000 (US)

905.851.9494 (CAN)

