

SS-1200

Stainless Steel High Pressure Flexible Coupling



Ensure coupling bolt pads make metal-to-metal contact. 
Always use the factory supplied Shurjoint Fast-Fit™ gasket. Performance standards do not support the use of a standard gasket in the SS-1200 coupling.

Job Name:	
Job Location:	
Engineer:	
Contractor:	
Tag:	
PO#:	
Rep:	
Wholesale Dist.:	

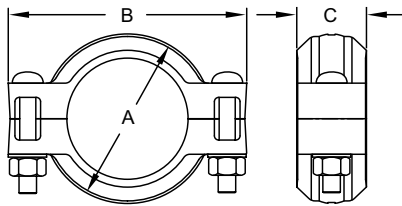

The Model SS-1200 is designed for high pressure applications including reverse osmosis, desalination and other specialty systems. The SS-1200 is available in strong and anti-corrosive alloys of Duplex CD3MN (2205), Super Duplex CE8MN, CE3MN (2507) and 6-Moly stainless steel CK3MCuN (254SMO*). The SS-1200 features 316 bolts, washers and silicon bronze nuts to help prevent galling during repetitive use. *254SMO is a registered trademark of Avesta Polarit AB.

The Shurjoint Model SS-5 is available with a standard "C" shaped or GapSeal gasket in a variety of grades to meet your specific service requirements.

DIMENSIONS

NOMINAL SIZE	PIPE O.D.	MAX. WORKING PRESSURE (CWP)**	MAX. END LOAD (CWP)	AXIAL DISPLACEMENT †	DIMENSIONS			DEFLECTION DEGREE †	BOLT		WEIGHT
					A	B	C		No	SIZE	
in	in	PSI	lb	in	in	in	in	(°)			lb
mm	mm	Bar	kN	mm	mm	mm	mm				kg
3/4*	1.050	1200	1040	0 - 0.06	2.09	3.70	1.81	3° - 23'	2	3/8 x 2-1/8	0.99
20	26.7	83	4.62	0 - 1.6	53	94	46				0.45
1	1.315	1200	1630	0 - 0.06	2.36	3.90	1.81	2° - 45'	2	3/8 x 2-1/8	1.21
25	33.4	83	7.25	0 - 1.6	60	99	46				0.55
1-1/4	1.660	1200	2595	0 - 0.06	2.76	4.17	1.81	2° - 10'	2	3/8 x 2-1/8	1.39
32	42.2	83	11.55	0 - 1.6	70	106	46				0.63
1-1/2	1.900	1200	3400	0 - 0.06	2.99	4.45	1.81	1° - 54'	2	3/8 x 2-1/8	1.54
40	48.3	83	15.13	0 - 1.6	76	113	46				0.70
2	2.375	1200	5315	0 - 0.06	3.50	5.31	1.85	1° - 31'	2	1/2 x 3	2.29
50	60.3	83	23.64	0 - 1.6	89	135	47				1.04
76.1 mm	3.000	1200	8470	0 - 0.06	4.01	6.04	1.91	1° - 15'	2	1/2 x 3	3.04
	76.1	83	38.19	0 - 1.6	102	153	49				1.38
3	3.500	1200	11540	0 - 0.06	4.69	6.61	1.85	1° - 02'	2	1/2 x 3	3.41
80	88.9	83	51.33	0 - 1.6	119	168	49				1.55
4	4.500	1200	19075	0 - 0.13	5.79	7.80	2.03	1° - 36'	2	5/8 x 3-1/2	4.69
100	114.3	83	84.86	0 - 3.2	147	198	52				2.13

Working pressure ratings are based upon generally accepted pressure piping design standards and testing in accordance with ASME Section VIII Division 1 pressure vessel test methods.

* Non-standard/stock items may require longer lead time.

** The working pressure shown is based on cut-grooved Sch. 40S or 80S pipe only. Burst test pressures are minimum 2 times the maximum working pressures.

† Allowable Axial Displacement and Angular Movement (deflection) figures are for roll grooved standard steel pipe. Values for cut grooved pipe will be double that of roll grooved. These values are maximums; for design and installation purposes these figures should be reduced by: 50% for 3/4"/DN20 - 3-1/2"/DN90; 25% for 4"/DN100 and larger to compensate for jobsite conditions.

FAST-FIT™ GASKET:

Easy installation with a single hand.

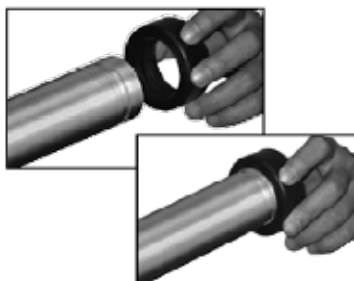

The Shurjoint Fast-Fit™ gasket has been designed and engineered for easier and faster installations. The pipe-end friendly design eliminates struggling to stretch the gasket over the pipe ends and the Fast-Fit™ gasket also features Shurjoint's GapSeal technology, which seals the gap between the pipe ends and eliminates stagnant water pockets within the gasket cavity. The Fast-Fit™ gasket is UL classified in accordance with NSF/ANSI 61 and NSF/ANSI 372 for potable water (Cold Water +86°F / 30°C and Hot Water +180°F / +82°C).

MATERIAL SPECIFICATIONS

HOUSING:

- Super duplex 2507 (CE3MN) to ASTM A890 Grade 5A
- Duplex 2205 (CD3MN) to ASTM Grade 4A
- Austenitic 254SMO (CK3MCuN) to A743

RUBBER GASKET:

Gr. E-pw EPDM (Color code: Double Green Strips)

- Good for cold +86oF (+30oC) and hot +180oF (+82oC) potable water services. EPDM is UL classified per NSF/ANSI 61 and NSF/ANSI 372.

(Option) Grade “E” EPDM (Color code: Green stripe)

- Good for cold & hot water up to +230°F (+110°C). Also good for services for water with acid, water with chlorine, deionized water, seawater and waste water, dilute acids, oil-free air and many chemicals.
- **Not recommended for petroleum oils, minerals oils, solvents and aromatic hydrocarbons.**
- Maximum Temperature Range: -30°F (-34°C) to +230°F (+110°C).
*EPDM gaskets for water services are not recommended for steam services unless couplings or components are accessible for frequent gasket replacement.

BOLTS:

- Type 316 Stainless steel track bolts to A193 B-8M Molybdenum disulfide (MoS₂) coated.

NUTS:

- Silicon bronze heavy duty nuts to ASTM B98 C65100

WASHERS:

- Type 316 stainless steel

PERFORMANCE DATA

The following tables show maximum cold working pressures (CWP) of Shurjoint stainless steel couplings used on stainless steel pipes. In general it is more difficult to achieve defined groove corners on stainless steel pipe than on carbon steel pipe. Always select the correct roll set for the pipe being grooved and process grooves as defined as possible. Contact your roll-groove tool manufacturer for recommendations.

NOM. SIZE	CUT-GROOVED	
	SCH. 80S	SCH. 40S
in	psi	psi
mm	Bar	Bar
3/4	1200	1200
20	83	83
1	1200	1200
25	83	83
1-1/4	1200	1200
32	83	83
1-1/2	1200	1200
40	83	83
2	1200	1200
50	83	83
2-1/2	1200	1200
65	83	83
3	1200	1200
80	83	83
4	1200	1200
100	83	83

*Proof test pressure: 1.5 times the listed working pressure.
Burst pressure: 3 times the listed working pressure.*

GENERAL NOTES

- Maximum Working Pressure (CWP) listed is the maximum cold water pressure for general piping services tested to ASTM F1476 and or AWWA C606 methods. Figures listed are based on roll- or cut-grooved standard wall carbon steel pipe. For other pipe schedules or pipe materials, contact Shurjoint for additional information.
- Max. End Load is calculated based on the maximum working pressure (CWP).
- Field Joint Test: For one time only the system may be tested hydrostatically at 1.5 times the maximum working pressure listed (AWWA C606 5.2.3).
- Warning: Piping systems must always be depressurized and drained before attempting disassembly and or removal of any components.
- The 10 Year Limited Warranty applies to manufacturing defects only and does not cover severe service/temperature applications or wear parts.
- Shurjoint reserves the right to change specifications, designs and or standard without notice and without incurring any obligations.