

94ALF-A series

full port brass ball valve
lead free



job name:	
job location:	
engineer:	
contractor:	
tag:	
po#:	
rep:	
wholesale dist.:	

description

the Apollo International™ 94ALF-A Lead Free* forged brass ball valve combines reliable operation with maximum economy. featuring multi-agency approvals, the 94alf-a is ideal for gas, fuels, fire protection and general plumbing and hvac applications including potable water. valves are ansi 3rd party lead free* certified.

features

- EZ Solder™ lead free materials**
- distinctive white "lead free" handle grip
- 2-piece, full port design
- blowout-proof stem
- 100% factory testing
- adjustable stem packing nut
- multiple agency approvals
- stem seal o-ring (solder version 1/2" - 2")

performance rating

- 600 CWP - 1/4" to 2"
- 400 CWP - 2-1/2" to 4"
- temperature range: 0°F to 400°F

UL listed

- UL 125 - flow control valves for LP-Gas, Guide YSDT to 250 psi max
- UL 258 - fire protection trim & drain, guide VQGU to 175psi max (1/4" - 2")
- UL 842 - valves for flammable fluids, guides YRBX, YRPV, and MHKZ to 250 psi max. (1/4" - 4" NPT only)
- UL 1477 - compressed gas shutoff valves, guide YQNZ to 250 psi max (1/4" - 4" NPT only)

*gas approvals apply to NPT models only | If locking lever kit option is installed, its position will be 180 degrees that of the standard lever.

approvals

- MSS SP-110 Ball Valves
- IAPMO/ANSI Z1157 Ball Valves
- NSF/ANSI/CAN 61 Water Quality
- NSF/ANSI/CAN 372 Lead Free
- EU Directive 2015/863 (RoHS 3) Compliant
- EU Regulation (EC) 1907/2006 (REACH) Compliant

FM listed

- FM 1140 fire protection quick opening valves

CSA listed

(File # 226234) per the following standards:

- ANSI Z21.15 (1/2 psi) (CSA 9.1) (1/4" - 2")
- ASME B16.44 (5 psi) (CR91-002) (1/4" - 2")
- ASME B16.33 (125 psi) (CGA 3.16) (1/4" - 2")

STANDARD MATERIALS LIST

body	lead free brass (DZR)
retainer	lead free brass (DZR)
ball 1/4" - 1"	lead free brass (DZR), Chr. plated
ball 1-1/4"- 4"	SS Type 316
stem	brass C36000
stem seal/o-ring	EPDM
seats	PTFE
stem packing	PTFE
gland nut	brass, C37700
seal	PTFE
handle	steel, plated (with PVC grip)
handle nut	steel, plated

**94ALF-2xx intended for soft solder installation using solders with melting temperature < 500°F.

dimensions

PART NUMBER	SIZE (IN.)	DIMENSIONS (IN.)					WT. (LB.)	KIT OPTIONS	
		A	B	C	D	E		2-1/4" STEM EXTENSION + MEMORY STOP	REPLACEMENT LEVER HANDLES
NPT									
94ALF-101-01A	1/4"	0.39	1.76	1.73	3.54	-	0.3	78217101	W234700
94ALF-102-01A	3/8"	0.39	1.76	1.73	3.54	-	0.3	78217201	W234800
94ALF-103-01A	1/2"	0.58	2.05	2.04	3.54	-	0.4	78217301	W234900
94ALF-104-01A	3/4"	0.75	2.36	2.26	3.78	-	0.7	78217401	W235000
94ALF-105-01A	1"	0.95	2.76	2.58	4.53	-	1.1	78217501	W235100
94ALF-106-01A	1-1/4"	1.26	3.31	3.05	4.53	-	1.6	78217601	W235200
94ALF-107-01A	1-1/2"	1.58	3.66	3.37	5.51	-	2.4	78217701	W235300
94ALF-108-01A	2"	1.97	4.18	3.70	6.30	-	3.4	78217801	W273800
94ALF-109-01A	2-1/2"	2.52	5.38	4.65	8.66	-	7.6		
94ALF-100-01A	3"	2.95	6.04	4.97	8.66	-	9.3		
94ALF-10A-01A	4"	3.95	7.39	6.13	11.02	-	16.9		
SOLDER									
94ALF-203-01A	1/2"	0.58	2.05	1.84	3.54	0.63	0.4	78217201	W234800
94ALF-204-01A	3/4"	0.75	2.75	2.14	3.78	0.88	0.7	78217301	W234900
94ALF-205-01A	1"	0.95	3.31	2.45	4.53	1.13	1.1	78217401	W235000
94ALF-206-01A	1-1/4"	1.26	3.82	3.04	4.53	1.38	1.4	78217501	W235100
94ALF-207-01A	1-1/2"	1.58	4.43	3.17	5.51	1.63	2.2	78217601	W235200
94ALF-208-01A	2"	1.97	5.38	3.49	6.30	2.13	3.0	78217701	W235300
94ALF-209-01A	2-1/2"	2.52	6.28	4.66	8.66	2.63	6.4	78217801	W273800
94ALF-200-01A	3"	2.95	7.15	4.87	8.66	3.13	8.5		
94ALF-20A-01A	4"	3.95	9.28	5.87	11.02	4.13	15.8		

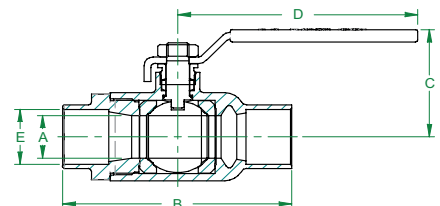
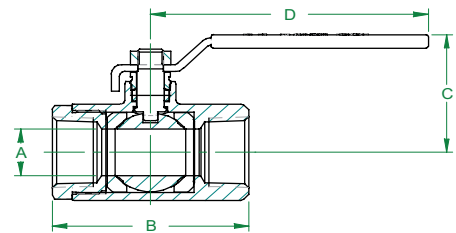

*lead free: the wetted surfaces of this product shall contain no more than 0.25% lead by weighted average. complies with federal public law 111-380. ANSI 3rd party approved and listed.