

# 10-100 Series

ASME Hot Water Safety Relief Valve



Job Name:	
Job Location:	
Engineer:	
Contractor:	
Tag:	
PO#:	
Rep:	
Wholesale Dist.:	

## DESCRIPTION

ASME Section IV Capacity Certified Bronze Safety Relief Valves protect ASME Section IV hot water heating boilers and hydronic heating systems. High capacity design features corrosion resistant construction. Brass, satin or polished chrome finishes available. Proudly made in the USA.

## FEATURES

- ASME Section IV Certified Capacity (20-60psi only)
- 15-60 psig (1.4 – 4.1 bar) Set Pressure at 250°F (121°C) max
- Corrosion Resistant Construction
- Registered in all Canadian Provinces and Territories CRN #OG8547.5C
- Stainless Steel Springs Standard
- Male or Female NPT inlet
- Optional Satin or Polished Chrome Finish
- **Made in the USA**

## APPROVALS

- ASME Section IV Heating Boilers
- Canadian Registration Number OG8547.5C

## OPTIONS

### CONNECTION

- Male NPT Inlet
- Female NPT Inlet

### FINISH

- Brass Finish
- Polished Chrome Finish
- Satin Chrome Finish

### SEAT

- EPDM
- Silicone

### SET PRESSURE

- 15-60, psig

## STANDARD MATERIALS LIST

<b>BODY</b>	ASTM B584 Bronze
<b>NOZZLE</b>	ASTM B584 Bronze
<b>SPRING</b>	Stainless Steel
<b>SEAT</b>	EPDM

## DIMENSIONS

PART NUMBER	SIZE (IN.)	DIMENSIONS (IN.) (MM)		
		A	B	C
10102	3/4F X 1F	1.50 (38)	3.41 (87)	1.53 (39)
10104	3/4M X 1F	1.91 (49)	3.82 (97)	1.53 (39)

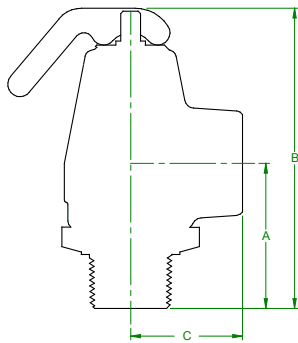

## CAPACITY

SET PRESSURE PSIG (BAR)	10-100 (1" OUTLET) BTU/HR
20 (1.38)	545,000
25 (1.72)	625,000
30 (2.07)	710,000
35 (2.41)	790,000
40 (2.76)	870,000
45 (3.10)	955,000
50 (3.45)	1,035,000
55 (3.79)	1,115,000
60 (4.14)	1,200,000