

94A series

full port brass ball valve



job name:	
job location:	
engineer:	
contractor:	
tag:	
po#:	
rep:	
wholesale dist.:	

description

the Apollo International™ 94A forged brass ball valve combines reliable operation with maximum economy. ideal for general flow control applications including hvac, fuel gases, and fire protection trim and drain etc. valves include most pertinent agency approvals.

features

- 2-piece, full port design
- blowout-proof stem
- adjustable stem packing nut
- 100% factory tested
- stem seal o-ring (solder version 1/2" - 2")
- MSS SP-110 Ball Valves
- **2 Year Warranty**

CSA listed

(file # 226234) per the following standards:

- ANSI Z21.1591-002) (1/4" - 4")
- ASME B16.33 (125 psi) (CGA 3.16) (1/4" - 2")

UL listed

- UL 125 - flow control valves for LP-Gas, guide YSDT to 250 psi max
- UL 258 - fire protection trim & drain, guide VQGU to 175psi max (1/4" - 2")
- UL 842 - valves for flammable fluids, guides YRBX, YRPV, and MHKZ to 250 psi max. (1/4" - 4" NPT only)
- UL 1477 - compressed Ggas shutoff valves, guide YQNZ to 250 psi max (1/4" - 4" NPT only)

*gas approvals apply to NPT models only

if locking lever kit option is installed, its position will be 180 degrees that of the standard lever.

performance rating

- 600 CWP - 1/4" - 4"
 - 400 CWP - 2-1/2" - 4"
 - temperature range: 0°F - 400°F
- *not for use in potable water applications in the United States.

FM listed

- FM 1140 fire protection quick opening valves

standard materials list

body	forged brass (Cu >57%)
retainer	forged brass (Cu >57%)
ball	brass, Cr plated
stem	brass, Cr plated
stem seal/o-ring	EPDM
seats	PTFE
stem packing	PTFE
gland nut	brass
handle	steel, plated (with PVC Grip)
handle nut	steel, plated

**94A-2xx intended for soft solder installation using solders with melting temperature < 500°F.

dimensions

PART NUMBER	SIZE (IN.)	DIMENSIONS (IN.)					WT. (LB.)	KIT OPTIONS	
		A	B	C	D	E		2-1/4" STEM EXTENSION + MEMORY STOP	REPLACEMENT LEVER HANDLES
NPT									
94A-101-01	1/4"	0.39	1.76	1.73	3.54	-	0.3	78217101	W932400
94A-102-01	3/8"	0.39	1.76	1.73	3.54	-	0.3		
94A-103-01	1/2"	0.58	2.05	2.04	3.54	-	0.4	78217201	W932500
94A-104-01	3/4"	0.75	2.36	2.26	3.78	-	0.7	78217301	W936000
94A-105-01	1"	0.95	2.76	2.58	4.53	-	1.1	78217401	W932600
94A-106-01	1-1/4"	1.26	3.31	3.05	4.53	-	1.6	78217501	W932700
94A-107-01	1-1/2"	1.58	3.66	3.37	5.51	-	2.4	78217601	W932800
94A-108-01	2"	1.97	4.18	3.70	6.30	-	3.4		W233200
94A-109-01	2-1/2"	2.52	5.38	4.65	8.66	-	7.6	78217701	W932900
94A-100-01	3"	2.95	6.04	4.97	8.66	-	9.3		
94A-10A-01	4"	3.95	7.39	6.13	11.02	-	16.9	78217801	W933000
SOLDER									
94A-203-01	1/2"	0.58	2.05	1.84	3.54	0.63	0.4	78217201	W932500
94A-204-01	3/4"	0.75	2.75	2.14	3.78	0.88	0.7	78217301	W936000
94A-205-01	1"	0.95	3.31	2.45	4.53	1.13	1.1	78217401	W932600
94A-206-01	1-1/4"	1.26	3.82	3.04	4.53	1.38	1.4	78217501	W932700
94A-207-01	1-1/2"	1.58	4.43	3.17	5.51	1.63	2.2	78217601	W932800
94A-208-01	2"	1.97	5.38	3.49	6.30	2.13	3.0		W233200
94A-209-01	2-1/2"	2.52	6.28	4.66	8.66	2.63	6.4	78217701	W932900
94A-200-01	3"	2.95	7.15	4.87	8.66	3.13	8.5		
94A-20A-01	4"	3.95	9.28	5.87	11.02	4.13	15.8	78217801	W933000

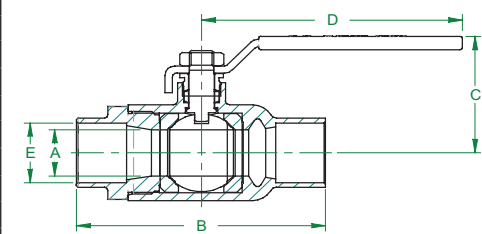
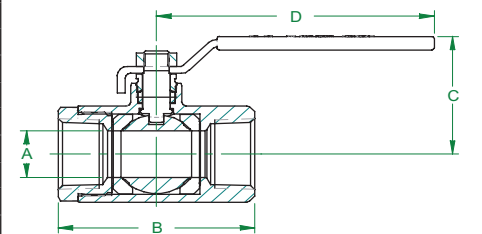



replacement lever handles kits

PART NO.	SIZE (IN.)	PRICE EA.
W932400	1/4", 3/8"	\$2.85
W932500	1/2"	\$2.85
W936000	3/4"	\$3.96
W932600	1"	\$4.54
W932700	1-1/4"	\$4.76
W932800	1-1/2", 2"	\$9.04
W932900	2-1/2", 3"	\$14.18
W933000	4"	\$16.54

latch lock lever kits

PART NO.	SIZE (IN.)	LIST PRICE EA.
78217202	1/4" 3/8"	\$8.86
78217302	1/2"	\$8.86
78217402	3/4"	\$9.61
78217502	1"	\$11.08
78217602	1-1/4"	\$13.29
78217702	1-1/2" & 2"	\$17.72
78217802	2-1/2" & 3"	\$23.63
78217902	4"	\$44.30

stem extension kits

PART NO.	SIZE (IN.)	PRICE EA.
78217101	1/4", 3/8"	\$20.59
78217201	1/2"	\$21.77
78217301	3/4"	\$22.81
78217401	1"	\$24.86
78217501	1-1/4"	\$26.99
78217601	1-1/2", 2"	\$35.23
78217701	2-1/2", 3"	\$47.25
78217801	4"	\$53.16

stainless steel lever & nut kit

PART NO.	SIZE (IN.)	LIST PRICE EA.
W932400S	1/4"-3/8"	\$7.38
W932500S	1/2"	\$7.09
W936000S	3/4"	\$10.93
W932600S	1"	\$11.81
W932700S	1 1/4"	\$13.29
W932800S	1 1/2"-2"	\$17.72
W932900S	2 1/2"-3"	\$29.54

tee handle kits

PART NO.	SIZE (IN.)	LIST PRICE EA.
W350312T	1/2"	\$2.77
W350334T	3/4"	\$3.55
W35031T	1"	\$4.14
W3503114T	1 1/4"	\$4.73