

10-322 Series

ASME Safety Valve



Job Name:	
Job Location:	
Engineer:	
Contractor:	
Tag:	
PO#:	
Rep:	
Wholesale Dist.:	

DESCRIPTION

ASME Section VIII design certified safety valve to protect portable steam vessel applications such as autoclaves, sterilizers and pressure cookers against excess build-up. Made from proved ASTM grade brass with optional decorative chrome finish.

FEATURES

- 15-60 psig Pressure Range
- Corrosion Resistant Construction
- Chrome Plate Finish Option
- Made in the USA

APPROVALS

- National Board (NB) Certified Capacity
- ASME Section VIII Div 1 Pressure Vessels for Steam, Air/Gas and Liquids
- Canadian Registration Number OG8547.5C Pressure Equipment Directive 2014/68/EU (PED)

STANDARD MATERIALS LIST

BODY	ASTM B16 Brass
NOZZLE	ASTM B62 Bronze
SPRING	Stainless Steel
SEAT	Steam Grade EPDM

*Set pressures and temperatures vary by model. Refer to catalog for sizing and selection information

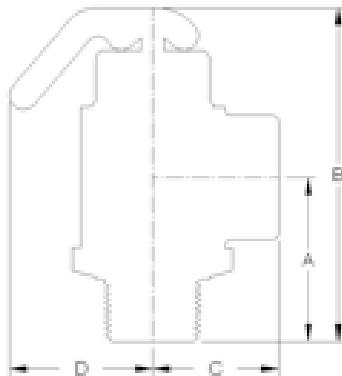

DIMENSIONS

PART NUMBER	SIZE (.IN)	DIMENSIONS (.IN)			
		A	B	C	D
10322	3/4M X 3/4F	1.81 (46)	3.69 (94)	1.38 (35)	1.56 (40)

PART NUMBER MATRIX

10	XXX	XX	X	X
SERIES NUMBER	MODEL	FINISH	SET PRESSURE	OPTION
10	322 (3/4" X 3/4")	B - PLAIN BRASS	SET PRESSURE, PSIG (2 DIGITS)	CE - PED/CE
		P - POLISHED CHROME		V - VITON

CAPACITY

SET PRESSURE PSIG (BAR)	10-322 CAPACITY LB/HR (KG/HR)
20 (1.38)	325 (147)
25 (1.72)	375 (170)
30 (2.07)	425 (193)
35 (2.41)	475 (215)
40 (2.76)	525 (238)
45 (3.10)	575 (261)
50 (3.45)	625 (284)
55 (3.79)	675 (306)
60 (4.14)	725 (329)